

1

2

3

4

A

B

C

D

E

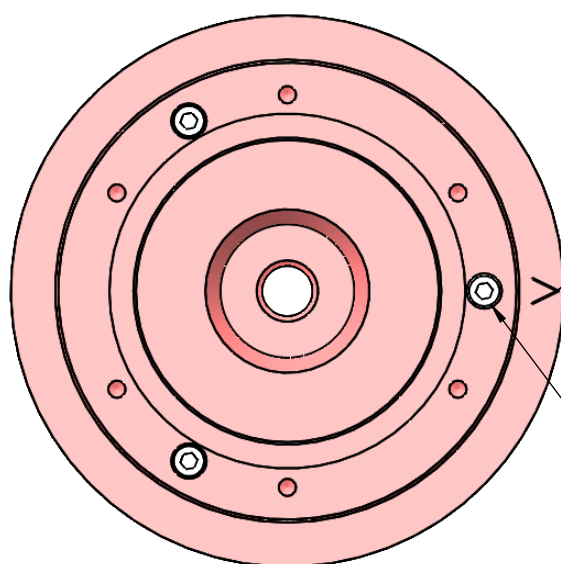

AHEAD

Observe Arrow position on sensor

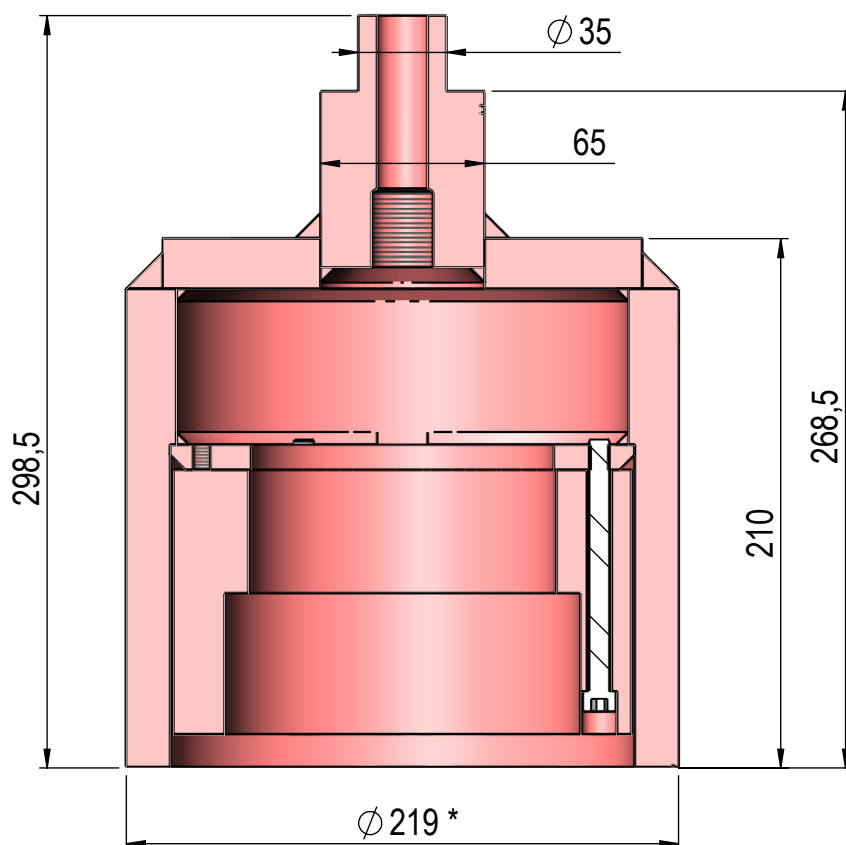

* Note. Due to surface mashing, the diameter may vary between 217 and 219

CN

Designed by - date
ST 2023.01.19

Approved by - date
GT 2023.01.19

*All sharp edges to be
broke or deburred*

Material

S355

Name

ETNSTCLF w/ETNAD adaptor

Drwg. no.

ETNSTCL

Revision

1223

Gen. tolerance
ISO2768m

Eur. projection



Scale
1 : 3

Edition date
2023.01.19

Sheet
1 of 2

SKIPPER

F

1

2

3

4

A

B

C

D

E

F

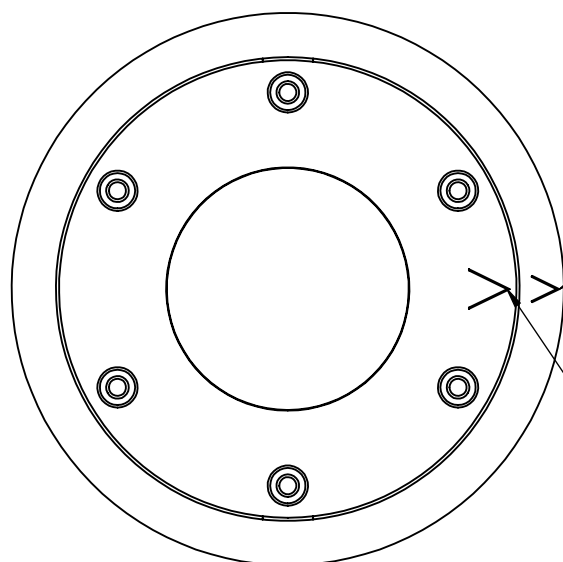

AHEAD

Observe Arrow position on sensor

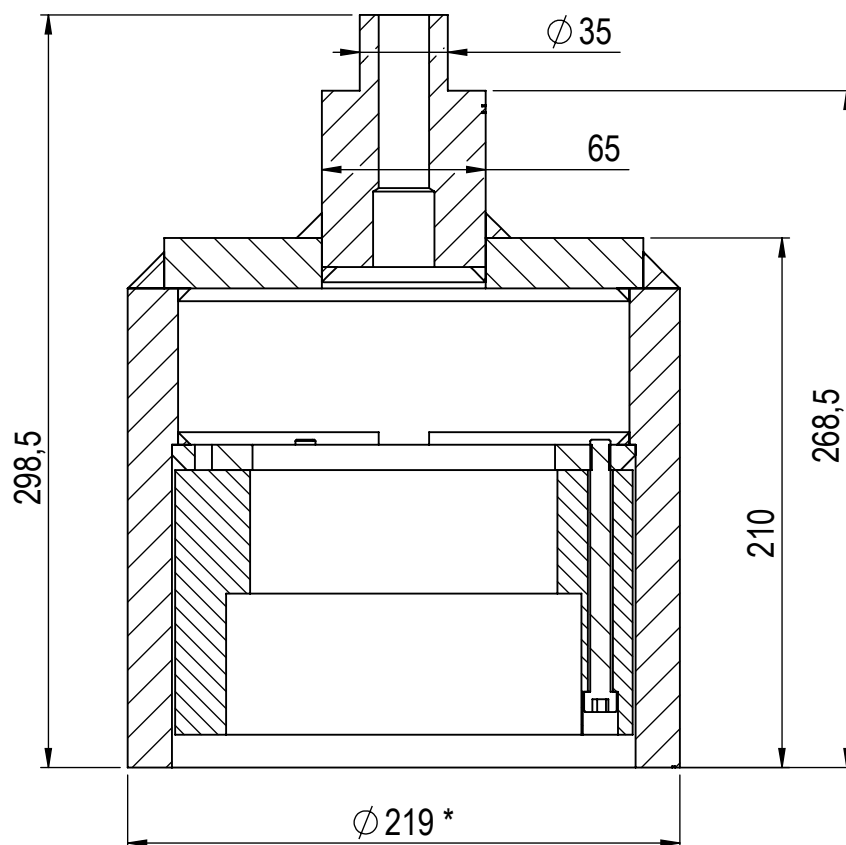

* Note. Due to surface machining, the diameter may vary between 217 and 219

CN

Designed by - date
ST 2023.01.19

Approved by - date
GT 2023.01.19

*All sharp edges to be
broke or deburred*

Material

S355

Name

ETNSTCLF w/ETNAD adaptor

Drwg. no.

ETNSTCL

Revision

1223

Gen. tolerance
ISO2768m

Eur. projection



Scale
1 : 3

Edition date
2023.01.19

Sheet
2 of 2

SKIPPER